



MLR/MLR60/90 Medium Pressure Receiver for CO₂ applications – 45/60/90 bar Operating Pressure

Medium Pressure Receivers for CO₂ Application Compact Housing for Operating Pressures up to 90 bar. MLR with additional connections for an external Standstill Cooling. 	Product Features: <ul style="list-style-type: none"> • Special Refrigerant Receiver for CO₂ • With all necessary connection incl. Flashgas By-pass • Connections suitable for brazing and welding • Connections designed for a safe and reliable operation • CE marked acc. PED 2014/68/EU • Powder Painted for excellent corrosion resistance • Combi connection for the safety valve, ½" NPT and 1-1/4 UNF
--	---

Pressure Equipment Directive	2014/68/EU	Media Compatibility:	CO ₂ , Mineral-, Synthetic- POE- and PAG lubricants
Applied Standards	EN 378/-1/-2, EN 14276-1, EN 1593, EN 1779	Material	Housing: Steel Pressure Connection: Steel Ni plated
Pressure Range:	max. oper. Pressure PS: 45/60/90 bar Test Pressure: PT: 64,4/85,8/129 bar	Temperature Range	-10°C to 135°C

Types and Capacities (all Connections for brazing and welding)

Type	P/N	Volum e (ltr.)	Liquid Line	Entry from Gascooler	Outlet Flashgas	Safety Valve	Ext. Heat Exchanger In/out	Sight Glass	Gewicht (kg)
MLR-V30	18357	30	16mm	16mm	16mm	22mm	22mm	2	
MLR-V60	18351	60	22mm	22mm	22mm				
MLR-V80	18352	80	22mm	22mm	22mm				
MLR-V110	18350	110	35mm	28mm	28mm				
MLR-V150	18349	150	35 mm						
MLR-V180	18353	180	28mm						
MLR-V250	18354	250	35mm	35mm	35mm				
MLR-V300	18360	300	42mm	42mm	42mm		3		
MLR-V350	18355	350							
MLR-V400	18361	400							
MLR-V570	18362	570							

Dimensions MLR

Type	P/N	PED Cat.	Modul	A	B	C	D	E	F
MLR-V30	18357	III	B+C1	924	696	290	776	230	219
MLR-V60	18351			900	610	290	690		323
MLR-V80	18352	IV	B+D	1117	855	290	935		
MLR-V110	18350			1510	1110	500	1250		
MLR-V150	18349			1643	1000	500	1098	400	
MLR-V180	18353			1653	1270	500	1368		
MLR-V250	18354			1500	1086	420	1166	260	480
MLR-V300	18360			1859	1516		1526		
MLR-V350	18355	2000	1586	1666					
MLR-V400	18361	2439	2026	2106	320	640			
MLR-V570	18362	2021	1586	1646					

MLR60/90

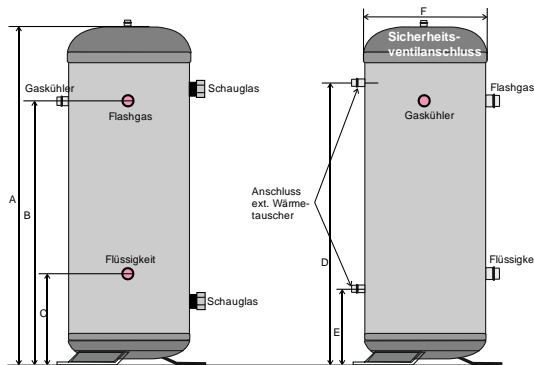

MLR

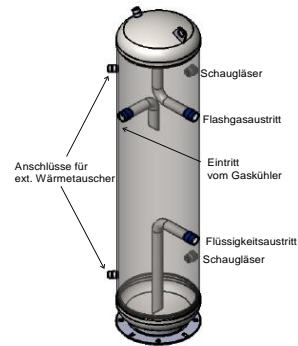

Technical Data MLR60/90

Type	P/N	Volume (l)	Inlet/Outlet (1)/(2), (mm ODF)	Sight Glass	Safety Valve (3)	PED Category
MLR60-6-12K	18900	6	12	1	½" NPT	II
MLR60-10-16K	18901	10	16			
MLR60-16-16K	18902	16		22		2
MLR60-20-22K	18903	20	28			
MLR60-30-22K	18904	30		35		
MLR60-40-28K	18905	40	35			IV
MLR60-40-28	18908	40		35		
MLR60-50-28K	18906	50	35			
MLR60-50-28	18909	50		35		
MLR60-80-35K	18907	80	35			1
MLR60-80-35	18910	80		2		
MLR90-6-12K	18950	6	12		1	½" NPT
MLR90-10-16K	18951	10	16			
MLR90-16-16K	18952	16		22	2	
MLR90-20-22K	18953	20	28			
MLR90-30-22K	18954	30		35		
MLR90-40-28K	18955	40	35		IV	
MLR90-40-28	18958	40		35		
MLR90-50-28K	18956	50	35			
MLR90-50-28	18959	50		35		
MLR90-80-35K	18957	80	35			
MLR90-80-35	18960	80		35		

Dimensions MLR60/90 (mm)

Type	A	B	D	E	F	G
MLR60-6-12K	140	./.	110	140	475	140
MLR60-10-16K	160	./.	130	160	550	168
MLR60-16-16K		310			870	168
MLR60-20-22K	180	460	150	180	630	219
MLR60-30-22K		740			905	219
MLR60-40-28K		345			555	324
MLR60-40-28					1210	219
MLR60-50-28K	220	495	195	220	710	324
MLR60-50-28					975	273
MLR60-80-35K		440			1110	324
MLR60-80-35					1545	273
MLR90-6-12K	150	./.	120	150	475	140
MLR90-10-16K		./.			550	168
MLRH90-16-16K		330			870	168
MLR90-20-22K	180	460	150	180	630	219
MLR90-30-22K		735			905	219
MLR90-40-28K		330			555	324
MLR90-40-28					1210	219
MLR90-50-28K	250	480	210	250	710	324
MLR90-50-28					975	273
MLR90-80-35K		470			1110	324
MLR90-80-35					1545	273

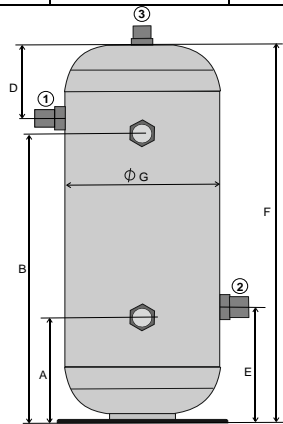
**Accessories: Level Sensors**

Type	COML P/N	COMH P/N	Supply Voltage	Signal	Max. oper. Pressure (bar)	Weight (g)	
						COML	COMH
COML/H-24	12057	12059	24 VAC	0,5A ind./1A ohmsch	COML: 60	465	535
COML/H-230	12058	12060	230 VAC		COMH: 120		

Minimal Required Liquid Density 0,5kg/l

Type Adapter	P/N	Connection	Weight (g)	Max. Oper. Pressure
COM-AD-012	12014	½" NPT	60	120 bar
COM-AD-114	12008	Rotalock 1-1/4"	105	
COM-AD-134	12007	Rotalock 1-3/4"	135	

Cables with Plug

Type	P/N	Supply Voltage	Length	Temperature range (static)	Application	Weight (g)
N300	12021	24 und	3,0 m	-40 ... +80°C	Supply Voltage	130
N600	12022	230 Vac	6,0 m			230
S300	12024	230 Vac	3,0 m		Relays	130
S600	12026		6.0 m			SPDT

Schematic CO2 Refrigeration Cycle with DEKA Components

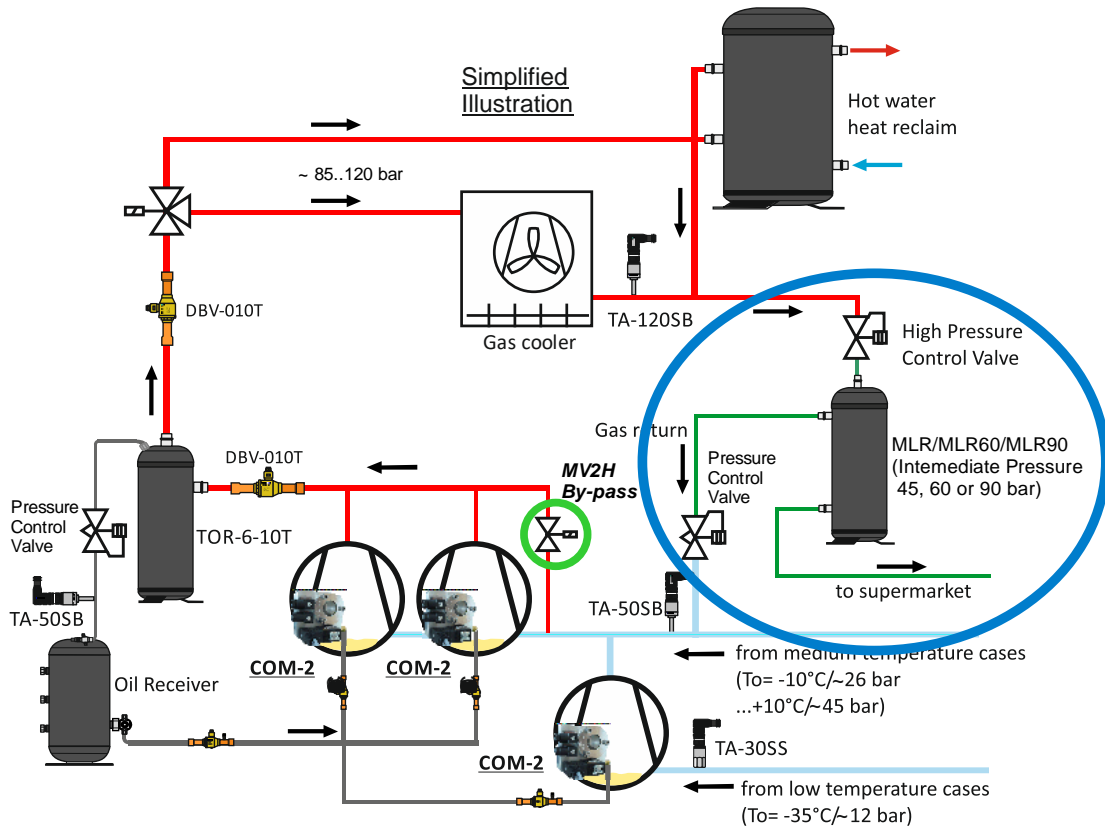

DEKA-Controls will not accept responsibility for possible errors in Technical literature and other printed material. DEKA Controls reserves the right to change his products without notice. This applies also to products already on order provided that such changes can be made without sub sequential changes being necessary in specifications already agreed.